



NUMBER: 08-023-07

GROUP: Electrical

DATE: October 06, 2007

This bulletin is supplied as technical information only and is not an authorization for repair. No part of this publication may be reproduced, stored in a retrieval system, or transmitted, in any form or by any means, electronic, mechanical, photocopying, or otherwise, without written permission of Chrysler LLC.

SUBJECT:

Long Crank Time Due To Possible Contact Of Camshaft Sensor To Camshaft Gear

OVERVIEW:

This bulletin involves the replacement of the engine camshaft sensor.

MODELS:

2007 (JK) Wrangler

NOTE: This bulletin applies to vehicles equipped with a 3.8L engine (sales code EGT).

SYMPTOM/CONDITION:

The customer may experience one of the following conditions:

- a). Long engine crank time.
- b). Two engine start attempts prior to engine starting.
- c). Due to the "TIP Start Feature" on automatic transmission equipped vehicles, once the ignition key / switch has been released from the "START" position, the starter may stay engaged for up to 10 seconds while the engine attempts to start.

The above conditions may be due to the position of the camshaft sensor to the camshaft gear. The sensor spacer gasket may have come loose during engine assembly and caused the camshaft sensor to be adjusted too close or in contact with the camshaft gear.

DIAGNOSIS:

If the above condition is present perform the Repair Procedure.

PARTS REQUIRED:

Qty.	Part No.	Description
1	04686353	Sensor, Camshaft

REPAIR PROCEDURE:

1. Disconnect and isolate the negative battery cable from the battery.
2. Disconnect the camshaft sensor electrical connector (Fig. 1).
3. Clean the area around the camshaft sensor and bore.
4. Remove the camshaft sensor mounting bolt.

5. Remove the camshaft sensor from engine with a pulling and rotating motion.
6. Verify that the old o-ring on the camshaft sensor was removed with the old camshaft sensor.

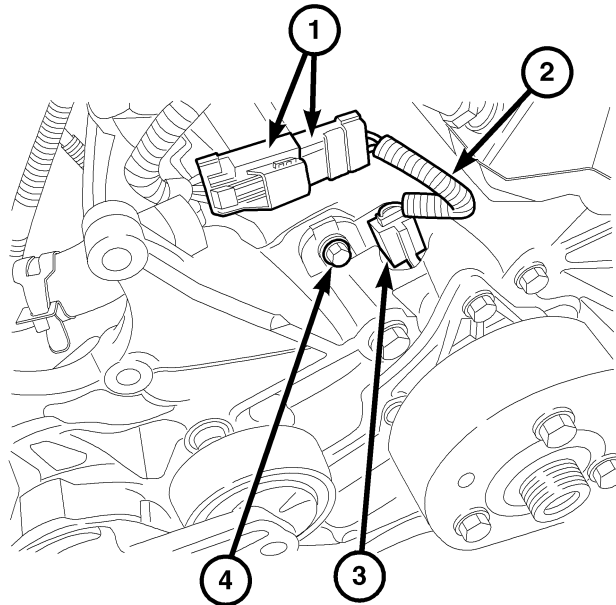

819127e5

Fig. 1 CAMSHAFT POSITION SENSOR 3.8L

- 1 - Camshaft Sensor To Engine Harness Connector
- 2 - Camshaft Sensor Electrical Lead
- 3 - Camshaft Sensor
- 4 - Camshaft Sensor Mounting Bolt

-
7. Apply a couple of drops of engine oil to the new camshaft sensor o-ring.

NOTE: Verify that the paper spacer is in position at the end / tip of the camshaft sensor.

8. Install the new camshaft sensor to the engine and rotate into position.
9. Push the new camshaft sensor down until contact is made with the camshaft gear.
10. While holding the new camshaft sensor in position against the camshaft gear, install and tighten the camshaft mounting bolt. Tighten the bolt to 14 Nm (125 in. lbs.).
11. Connect the camshaft sensor lead to the engine harness connector.
12. Connect the negative battery cable to the battery.

POLICY:

Reimbursable within the provisions of the warranty.

TIME ALLOWANCE:

Labor Operation No:	Description	Amount
08-15-79-90	Camshaft Sensor - Replace (A)	0.2 Hrs.

FAILURE CODE:

ZZ	Service Action
----	----------------